

# DOUBLE SYNCHRONIZER MECHANISM STRUCTURE [G35M-R]

---

B3E051501025T13

## Features

- A double cone synchronizer mechanism is used for the 1st and 2nd gears.
- The double cone synchronizer mechanism is a compact device capable of heavy duty meshing.
- The synchronizer mechanism reduces meshing time and improves operation.
- The double cone synchro mechanism includes a synchronizer ring, double cone, and an inner cone.

## Structure

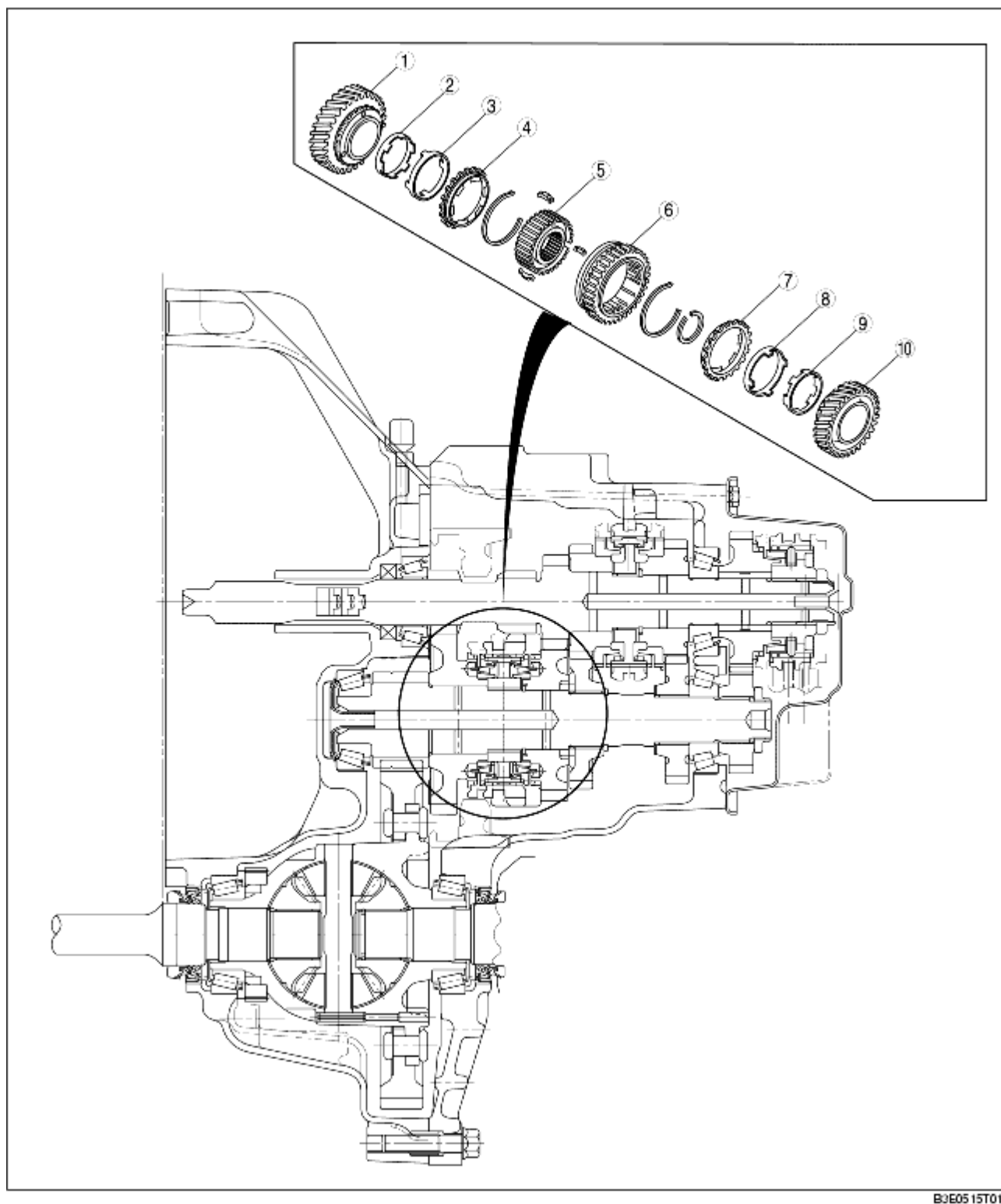

B3E05 15T017

1	1st gear
2	Inner cone
3	Double cone
4	Synchronizer ring
5	Clutch hub
6	Clutch hub sleeve

7	Synchronizer ring
8	Double cone
9	Inner cone
10	2nd gear